

DR (610) Series

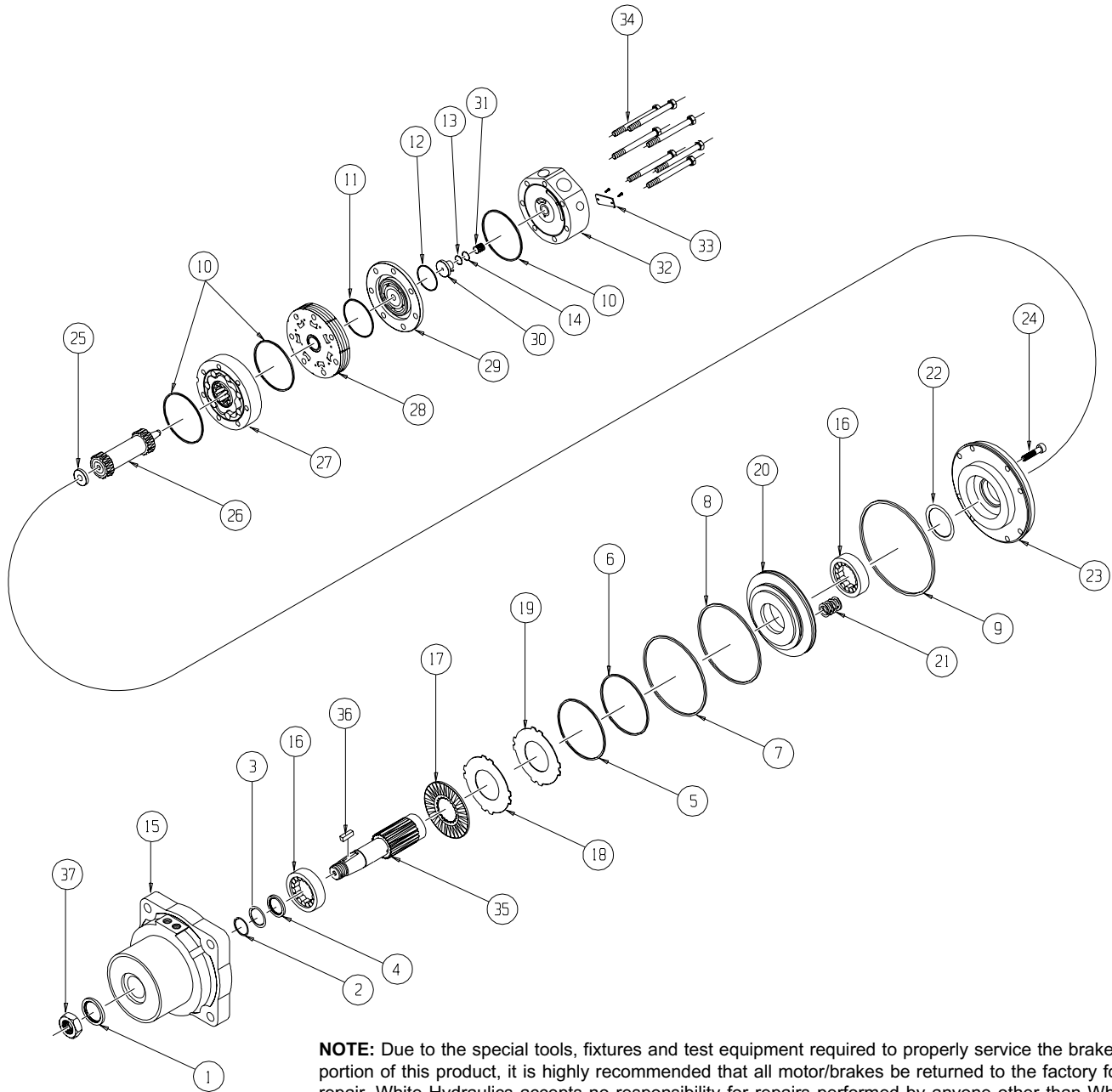

NOTE: Due to the special tools, fixtures and test equipment required to properly service the brake portion of this product, it is highly recommended that all motor/brakes be returned to the factory for repair. White Hydraulics accepts no responsibility for repairs performed by anyone other than White Hydraulics factory service personnel. To inquire about repairs and obtain return authorization for a product, please contact the technical support department at 800-323-7298.

DR (610) SERIES BRAKE MOTOR COMPONENTS

SEAL KIT 700666750

DESCRIPTION	EXP.VIEW ITEM #	KIT
DUST SEAL	1	ITEMS #1-14 INCLUDED IN SEAL KIT 700666750
METAL BACKUP SHIM	2	
TEFLON BACKUP SEAL	3	
SHAFT SEAL	4	
SMALL O-RING SEAL	5	
SMALL TEFLON SEAL	6	
LARGE O-RING SEAL	7	
LARGE TEFLON SEAL	8	
O-RING SEAL	9	
BODY SEALS (3)	10	
MANIFOLD SEAL	11	
COMMUTATOR SEAL	12	
PISTON O-RING SEAL	13	
PISTON TEFLON SEAL	14	

MISCELLANEOUS KITS

DESCRIPTION	EXP. VIEW ITEM #	KIT
SHAFT BEARING (1 PER KIT)	16	910018011
FRICTION DISKS & STAMPINGS (22)	17-19	600018232
PISTON	20	700018088
SPRINGS (25 PER KIT)	21	910018014
SPACER SHIMS (3 PER KIT)	22	300018068
CAPSCREWS (8 PER KIT)	24	200018074
DRIVE LINK SPACER	25	500018075
MANIFOLD	28	700668002
COMMUTATOR ASSEMBLY	29	700668003
ENDCOVER PISTON	30	700668004
PISTON SPRING	31	700018046
1000 PSI RELIEF VALVE	NOT SHOWN	500018228
2000 PSI RELIEF VALVE	NOT SHOWN	500018231
3000 PSI RELIEF VALVE	NOT SHOWN	500018221
1.125-18 UNEF SLOTTED HEX NUT	37	700018038
1.125-18 UNEF SOLID HEX NUT	37	700018054

ROTORS, DRIVE LINKS, AND BOLTS

WHEN CHANGING MOTOR DISPLACEMENTS, A MATCHING ROTOR, DRIVE LINK AND BOLT SET KIT MUST BE ORDERED.

EXPLODED VIEW ITEM #	27	27	26	34
DISPLACEMENT	STANDARD ROTOR KIT	FREETURN ROTOR KIT	DRIVE LINK KIT	BOLT SET KIT
200	500167004	500167011	600140012	700664012
260	500227000	500227004	600140016	700664019
300	500247005	500247011	600140019	700664025
350	500207000	500207004	600140027	700665028
375	500307005	500307011	600140025	700664028
470	500357003	500357005	600140027	700665028
540	500407005	500407011	600140033	700665033
750	500607005	500607011	600140046	700665046

HOUSING KITS (EXPLODED VIEW ITEM #S 15 & 23)

DESCRIPTION	HOUSING KIT
#W2& W8- DR SETBACK BRAKE (EXPLODED VIEW ITEM #15)	300130054
REAR HOUSING (EXPLODED VIEW ITEM #23)	500013067

SHAFTS AND RELATED COMPONENTS KITS

SHAFT KITS COME WITH RELATED SHAFT COMPONENTS (i.e. keys, nuts, etc.)

TO ORDER INDIVIDUAL SHAFT COMPONENTS (i.e. keys, nuts, bolts, washers or wire rings) USE THE KIT NUMBER FOR EACH INDIVIDUAL PART.

EXPLODED VIEW ITEM #	35	36	37
DESCRIPTION	SHAFT KIT	KEY KIT	NUT KIT
#30- 1-1/2" STRAIGHT	600011215	300339105	SEE MISC. KITS
#31- 1-1/2" TAPERED	600011308	500449102	ABOVE

ENDCOVER KITS (EXPLODED VIEW ITEM #32)

ENDCOVER KITS COME ASSEMBLED WITH EXPLODED VIEW ITEMS # 13, 14, 30 & 31.

TO ORDER A RELIEF VALVE FOR THE VALVE CAVITY ENDCOVERS, SEE THE MISCELLANEOUS KITS LISTING ABOVE FOR RELIEF VALVE KIT #S.

DESCRIPTION	STANDARD ENDCOVER	VALVE CAVITY ENDCOVER KIT
#1- 7/8" O-RING REAR PORTS	700160000	700160000R
#5- 1-1/16" O-RING RADIAL PORTS	700160005	700160005R
#2- 3/4" BSP.F RADIAL PORTS	700160007	700160007R
#6- 1-1/16" O-RING PARALLEL PORTS	700160008	700160008R
#7- 3/4" BSP.F PARALLEL PORTS	700160009	---